

City of Charlotte
Site Plan Application

Date 4-25-16

Per Section 82-471(A)2

Applicant's Name Tim Bahmer

Address 211 Munson St.

Telephone Day: 517-543-9949 Evening _____

Owners Name Timothy and Angela Bahmer

Architect or Engineers Name _____

Address: _____

Telephone: _____

Address and location of property 211 Munson St.

Legal description of property (attach drawing where appropriate) _____

See attached legal description & site plan drawing.

Proposed use of property Use will not change. Proposing new additions to east & west sides of main building. Use is auto repair.

Interest in property (check one):

Owner Option Tenant

Current zoning (check one):

R-1 R-2 RT RM-1 RM-2 MH
 OS-1 B-1 B-2 B-3 CBD PD
 IRO I-1 I-2 P-1

Current use (check one):

Residential Vacant Office Industrial _____
 Institutional Commercial

The Planning Commission meets on the first Tuesday of the Month at 7:00 p.m. in the City Hall Council Chambers. To make a request for a Public Hearing before the Planning Commission, file this application with the City of Charlotte, attention Ginger Terpstra, City Clerk, 111 East Lawrence, Charlotte, MI 48813. This application must be received no later than the date set by the City Clerk, and must include the following attachments:

1. \$100.00 Fee
2. 15 copies of the site plan addressing all of the check list items. A copy of the check list is attached.

Please contact this department concerning the dates for submittal. Any questions concerning these requirements should be directed to Bryan Myrkle at (517) 543-8853. The applicant or a representative must be present in order for the Commission to consider the request.

Tim Bahmer
Signature of Applicant

4-27-16
Date

Tim Bahmer – Tim’s Auto Repair – 211 Munson Street

Legal Description:

THAT PART OF S 15 ACRES OF N 30 ACRES OF W FRL 1/2 OF SW FRL 1/4 N OF C/L MUNSON ST, E OF E LINE OF WASHINGTON ST EXTENDED N & SE OF RR SUB TO R/W ON W 260 FT OF S 20 FT. AND ALSO 57.8 FT N & S BY 215 FT E & W IN NW COR OF THAT PART OF S 5 ACRES OF N 35 ACRES OF W FRL 1/2 OF SW FRL 1/4 LYING E OF WASHINGTON ST. SEC 7, T2N,R4W, CITY OF CHARLOTTE. AND ALSO COM CEN MUNSON ST AT E LINE OF WASHINGTON ST, N 175 FT, W TO RR R/W, SWLY ALG RR TO W LINE OF WASHINGTON ST EXTENDED, S TO CEN MUNSON ST, E 60 FT TO BEG. D 08-18-11 COMBINED ON 12/12/2011 FROM 200-007-300-300-01, 200-007-300-305-00;

Site Plan - 211 Monson

Tim Bahmer

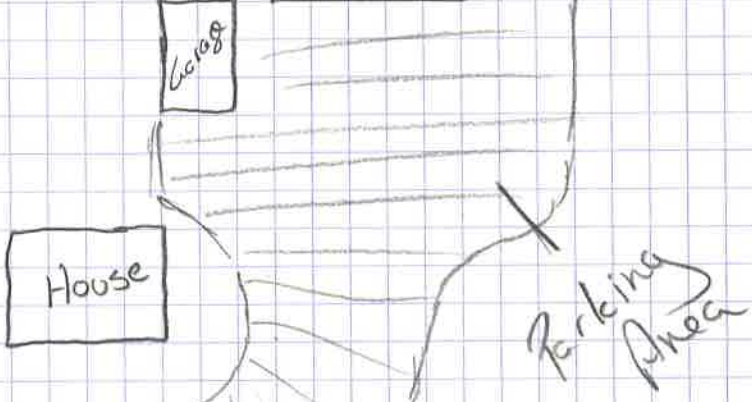
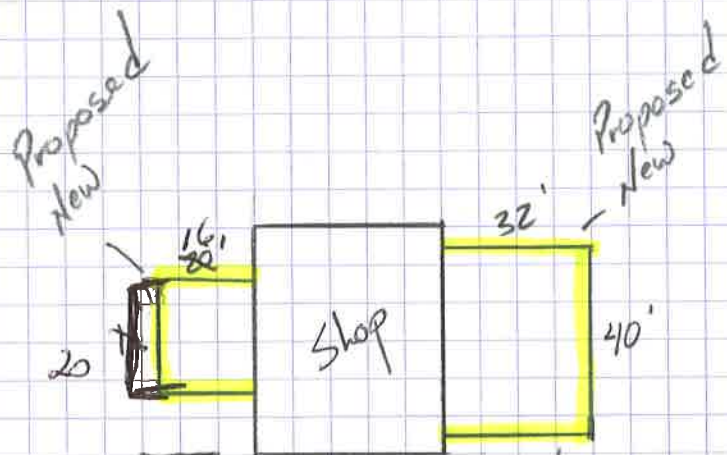

Monson

Washington

BAHMER
543-9949

