

- BENCHMARKS:**
- BM#1- FINISH FLOOR ELEVATION OF EATON COUNTY ROAD COMMISSION BUILDING AT MAIN OFFICE ENTRANCE ELEVATION= 894.33
 - BM#2- RAILROAD SPIKE EAST SIDE UTILITY POLE, WEST SIDE REYNOLDS STREET AT NORTHWEST CORNER OF SPARTAN MOTORS SITE ELEVATION= 894.66
 - BM#3- TVS HYDRANT AT THE SOUTH END OF REYNOLDS STREET ON THE WEST SIDE OF THE STREET ELEVATION= 894.47
 - BM#4- SPIKE IN SOUTH SIDE OF UTILITY POLE, WEST SIDE OF MIKESSELL STREET AT ENTRANCE GATE TO SPARTAN MOTORS ELEVATION= 893.13

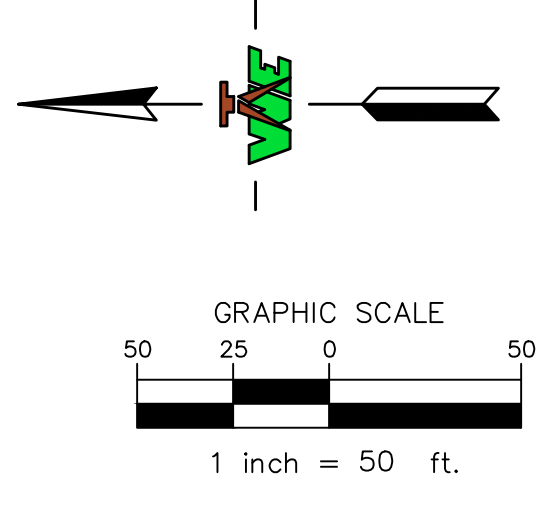

Know what's below.
Call before you dig.

!!! CAUTION !!!
THE LOCATIONS AND ELEVATIONS OF EXISTING UNDERGROUND UTILITIES AS SHOWN ON THIS DRAWING ARE ONLY APPROXIMATE. NO GUARANTEE IS EITHER EXPRESSED OR IMPLIED AS TO THE COMPLETENESS OR ACCURACY THEREOF. THE CONTRACTOR SHALL BE EXCLUSIVELY RESPONSIBLE FOR DETERMINING THE EXACT UTILITY LOCATIONS AND ELEVATIONS PRIOR TO THE START OF CONSTRUCTION. IT IS THE CONTRACTOR'S RESPONSIBILITY TO NOTIFY THE VARIOUS UTILITY OWNERS IN ACCORDANCE WITH MICHIGAN P.A. NO. 53 OF 1974.

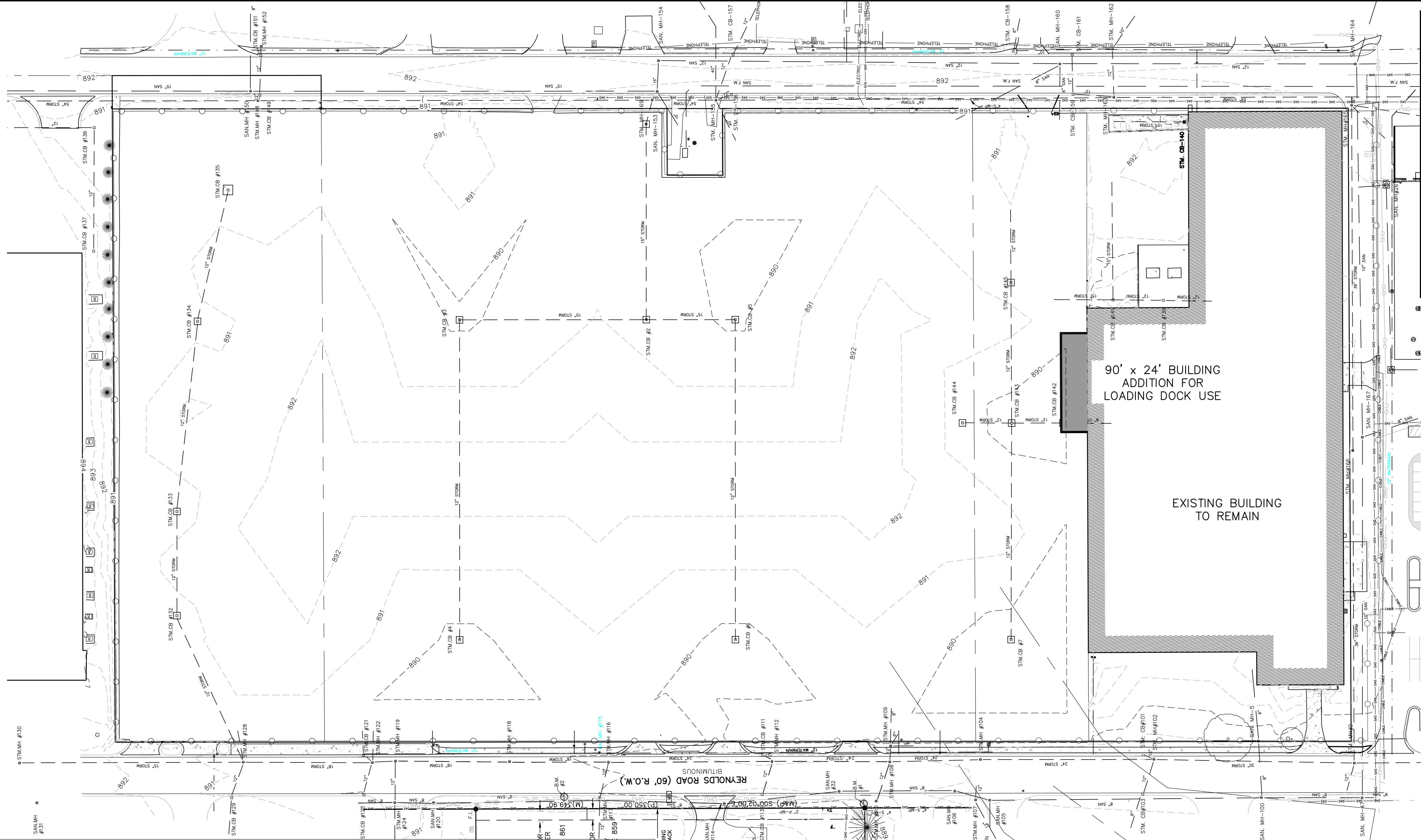

90' x 24' BUILDING ADDITION FOR LOADING DOCK USE

EXISTING BUILDING TO REMAIN

EXISTING STRUCTURE INFORMATION																																																									
SAN MH 131 R.E. 893.38 I.E. 8" N 885.96 I.E. 8" S 885.86	SAN MH 5 R.E. 890.07 I.E. 6" E 886.12 I.E. 6" E 884.32 I.E. 6" NE 884.32 I.E. 15" W 875.12	SAN MH 154 R.E. 891.77 I.E. 15" N 875.12 I.E. 8" NE 883.32 I.E. 15" W 875.12	STM MH 128 R.E. 890.70 I.E. 15" N 884.50 I.E. 12" NE 885.94 I.E. 12" NE 885.25 I.E. 12" W 885.78 I.E. 18" S 884.27	STM MH 122 R.E. 890.12 I.E. 18" N 884.08 I.E. 12" SE 883.49	STM CB 113 R.E. 888.49 I.E. 12" SW 886.21 I.E. 12" E 884.95	STM MH 107 R.E. 889.00 I.E. 12" SW 886.21 I.E. 12" E 884.95	STM MH 165 R.E. 892.40 I.E. 36" W 878.75 I.E. 12" SW 882.505 I.E. 36" E 878.75	STM CB 156 R.E. 891.26 I.E. 12" NNW 886.96 I.E. 12" SW 882.505 I.E. 36" E 878.75	STM MH 147 R.E. 892.88 I.E. 54" N 879.73 I.E. 12" S 886.22	STM CB 142 R.E. 889.91 I.E. 12" S 886.22 I.E. 12" N 886.22	STM MH 120 R.E. 890.98 I.E. 8" N 886.30 I.E. 8" S 886.15	SAN MH 47 R.E. 889.17 I.E. 15" E 875.30 I.E. 8" N 877.59 I.E. 10" E 877.52 I.E. 8" S 877.75	SAN MH 153 R.E. 891.80 I.E. 15" E 875.30 I.E. 15" N 875.15 I.E. 8" W 886.68 I.E. 15" SW 875.15	STM CB 129 R.E. 890.93 I.E. 8" W 886.68 I.E. 12" E 886.68	STM MH 119 R.E. 890.04 I.E. 18" N 884.04 I.E. 12" W 883.99 I.E. 18" S 884.01	STM MH 112 R.E. 888.77 I.E. 24" N 882.65 R.E. 887.84 I.E. 54" S 877.87	STM CB 103 R.E. 891.51 I.E. 54" N 878.71 I.E. 15" NW 883.66 I.E. 54" S 878.71	STM MH 169 R.E. 891.51 I.E. 54" N 878.71 I.E. 15" NW 883.66 I.E. 54" S 878.71	STM CB 141 R.E. 888.06 I.E. 12" S 884.36 I.E. 15" N 884.06 I.E. 15" E 884.44	STM CB 2 R.E. 890.60 I.E. 15" S 884.54 I.E. 15" N 884.54 I.E. 15" E 884.44	SAN MH 32 R.E. XXX.XX I.E. 8" N XXX.XX I.E. 8" S XXX.XX	SAN MH 167 R.E. 891.63 I.E. 10" W 876.63 I.E. 8" SE 883.03 I.E. 10" E 876.58	SAN MH 150 R.E. 891.05 I.E. 8" E 882.80 I.E. 15" N 875.85 I.E. 15" S 875.80	STM CB 132 R.E. 890.57 I.E. 12" E 885.24 I.E. 12" W 885.24	STM CB 121 R.E. 889.80 I.E. 6" NE 886.15 I.E. 12" SW 886.30	STM MH 110 R.E. 889.16 I.E. 6" NE 886.15 I.E. 12" SW 886.30	STM CB 101 R.E. 87.82 I.E. 12" W 884.74 I.E. 12" SW 885.90	STM MH 102 R.E. 888.11 I.E. 24" N 880.96 I.E. 12" NE 883.86 I.E. 6" SE 886.61 I.E. 12" NW 883.86 I.E. 30" S 880.96	STM CB 159 R.E. 891.03 I.E. 12" E 884.73 I.E. 12" SSW 884.43 I.E. 54" N 879.19 I.E. 12" SE 884.79 I.E. 12" N 885.46	STM MH 148 R.E. 891.54 I.E. 54" N 879.19 I.E. 12" W 884.50 I.E. 54" S 879.19	STM CB 145 R.E. 890.60 I.E. 12" S 884.50 I.E. 12" E 884.40	STM CB 139 R.E. 887.81 I.E. 12" S 885.56 I.E. 12" N 885.46	STM CB 3 R.E. 889.80 I.E. 12" W 885.16 I.E. 15" S 884.96	SAN MH 106 R.E. 888.77 I.E. 8" N 882.62 I.E. 8" S 882.59 I.E. 12" S 876.15 I.E. 12" N 875.95	SAN MH 164 R.E. 892.40 I.E. 10" W 876.00 I.E. 8" SE 876.10 I.E. 12" S 876.15 I.E. 12" N 875.95	SAN MH 146 R.E. 892.84 I.E. 6" W 883.84 I.E. 15" N 876.84 I.E. 15" S 876.84	STM CB 133 R.E. 890.38 I.E. 12" E 885.35 I.E. 12" W 885.35	STM MH 118 R.E. 889.44 I.E. 18" N 883.84 I.E. 6" SE 886.61 I.E. 12" NW 883.86 I.E. 18" S 883.94	STM MH 109 R.E. 889.41 I.E. 8" E 888.06 I.E. 6" SE 886.61 I.E. 6" S 886.57 I.E. 12" W 885.21	STM CB 157 R.E. 891.37 I.E. 18" NE 884.78 I.E. 12" SE 883.87 I.E. 12" S 885.93 I.E. 54" S 879.73	STM MH 162 R.E. 892.04 I.E. 10" N 885.34 I.E. 10" SE 885.34 I.E. 12" W 884.74 I.E. 12" NW 884.95	STM CB 149 R.E. 890.75 I.E. 12" E 885.00 I.E. 12" NW 884.95	STM CB 139 R.E. 887.81 I.E. 12" S 885.56 I.E. 12" N 885.46	STM CB 4 R.E. 889.70 I.E. 12" E 886.17 I.E. 12" E 886.17	SAN MH 105 R.E. 888.79 I.E. 8" N 882.36 I.E. 6" W 882.39 I.E. 8" NW 882.50 I.E. 12" S 875.65	SAN MH 160 R.E. 891.65 I.E. 6" W 882.39 I.E. 8" NW 882.50 I.E. 12" S 875.65	SAN MH 146 R.E. 892.84 I.E. 6" W 883.84 I.E. 15" N 876.84 I.E. 15" S 876.84	STM CB 134 R.E. 890.61 I.E. 12" E 885.51 I.E. 12" W 885.51	STM MH 130 R.E. 893.44 I.E. 12" E 885.51 I.E. 12" W 885.51	STM MH 117 R.E. 889.19 I.E. 15" N 886.40 I.E. 12" SE 887.94 I.E. 12" SW 888.24 I.E. 15" S 886.27	STM CB 135 R.E. 890.33 I.E. 12" SW 888.24 I.E. 15" S 886.27	STM MH 116 R.E. 889.79 I.E. 12" W 885.42 I.E. 24" S 883.18	STM MH 108 R.E. 889.00 I.E. 24" N 882.50 I.E. 12" NW 884.50 I.E. 12" E 884.50 I.E. 36" E 880.06 I.E. 40" SW 878.72 I.E. 40" SE 886.67 I.E. 12" SSE 886.67 I.E. 36" W 879.70 I.E. 36" E 879.65	STM MH 2 R.E. 888.86 I.E. 30" N 880.46 I.E. 12" N 883.81 I.E. 12" S 881.66 I.E. 40" E 878.72 I.E. 40" SW 878.72 I.E. 12" SE 886.67 I.E. 15" W 887.18 I.E. 12" S 885.46	STM MH 155 R.E. 891.57 I.E. 15" E 886.91 I.E. 54" N 878.22 I.E. 40" E 878.72 I.E. 40" SW 878.72 I.E. 12" SE 886.67 I.E. 15" W 887.18 I.E. 12" S 885.46	STM MH 152 R.E. 891.38 I.E. 40" SW 878.72 I.E. 12" SE 886.67 I.E. 15" W 887.18 I.E. 12" S 885.46	STM CB 144 R.E. 888.06 I.E. 12" S 885.46

NOTE: THE LOCATION OF THE EXISTING UNDERGROUND UTILITIES HAVE BEEN EITHER FIELD VERIFIED OR LOCATED BASED ON UTILITY COMPANY'S INFORMATION. ANY OTHER UNDERGROUND UTILITY NOT ON PUBLIC RECORD HAS NOT BEEN SHOWN AND WOLVERINE ENGINEERS AND SURVEYORS, INC. TAKES NO RESPONSIBILITY OF THESE UNKNOWN UTILITIES.

LEGAL DESCRIPTION:
A PARCEL OF LAND ON PART OF THE WEST 1/2 OF THE NORTHWEST 1/4, SECTION 24, T2N, R5W, CITY OF CHARLOTTE; COMMENCING AT THE NORTHWEST CORNER OF SECTION 24; THENCE N89°43'04"E 1324.96 FEET ALONG THE NORTH LINE OF SAID SECTION 24; THENCE S00°02'00"E 901.00 FEET ALONG THE EAST LINE OF THE WEST 1/2 OF THE NORTHWEST 1/4 OF SAID SECTION 24 TO THE POINT OF BEGINNING; THENCE S00°02'00"E 188.00 FEET; THENCE S89°44'10"W 30.00 FEET; THENCE S00°02'00"E 311.00 FEET; THENCE S89°44'10"W 60.00 FEET; THENCE S00°02'00"E 50.00 FEET; THENCE N89°44'10"E 60.00 FEET; THENCE S00°02'00"E 562.80 FEET; THENCE S89°44'10"W 570.00 FEET; THENCE N00°02'00"W 1111.80 FEET; THENCE N89°44'10"E 600.00 FEET TO THE POINT OF BEGINNING, SUBJECT TO ALL EASEMENTS AND RIGHTS OF WAY OF RECORD.

NOT FOR CONSTRUCTION

PROJECT: PLANT 12 NEW BUILDING & PARKING LOT
CITY OF CHARLOTTE
EATON COUNTY, MICHIGAN
SHEET TITLE: PRELIMINARY RENOVATION BUILDING ADDITION PLAN

APPROVED	JCW
CHECKED	JCW
DRAWN	JMS
JOB NO.	15-0065
DATE	9/10/15
SCALE	1" = 50'
SHEET NO.	C2

REVISION: _____ DATE: _____
DRAWN: _____ DESCRIPTION: _____

WOLVERINE
Engineers & Surveyors, Inc.
312 North Street
Mason, Michigan 48854
Ph: 317 676 5200
FAX: 317 676 9396
http://www.woleng.com

COPYRIGHT © 2014 WOLVERINE ENGINEERS AND SURVEYORS, INC. ALL DRAWINGS AND WRITTEN INFORMATION ARE THE PROPERTY OF WOLVERINE ENGINEERS AND SURVEYORS, INC. AND THE SAME MAY NOT BE REPRODUCED, COPIED, DISSEMINATED OR DISCLOSED WITHOUT PRIOR WRITTEN CONSENT OF WOLVERINE ENGINEERS AND SURVEYORS, INC.



SPARTAN MOTORS
 CAREFREE
 RENOVATION
 CHARLOTTE, MICHIGAN

PROJECT



THE WIELAND - DAVCO
 CORPORATION

CONSULTANT

COMPOSITE
 FLOOR PLAN

SHEET TITLE

14-155

PROJECT NUMBER

A-011

SHEET NUMBER

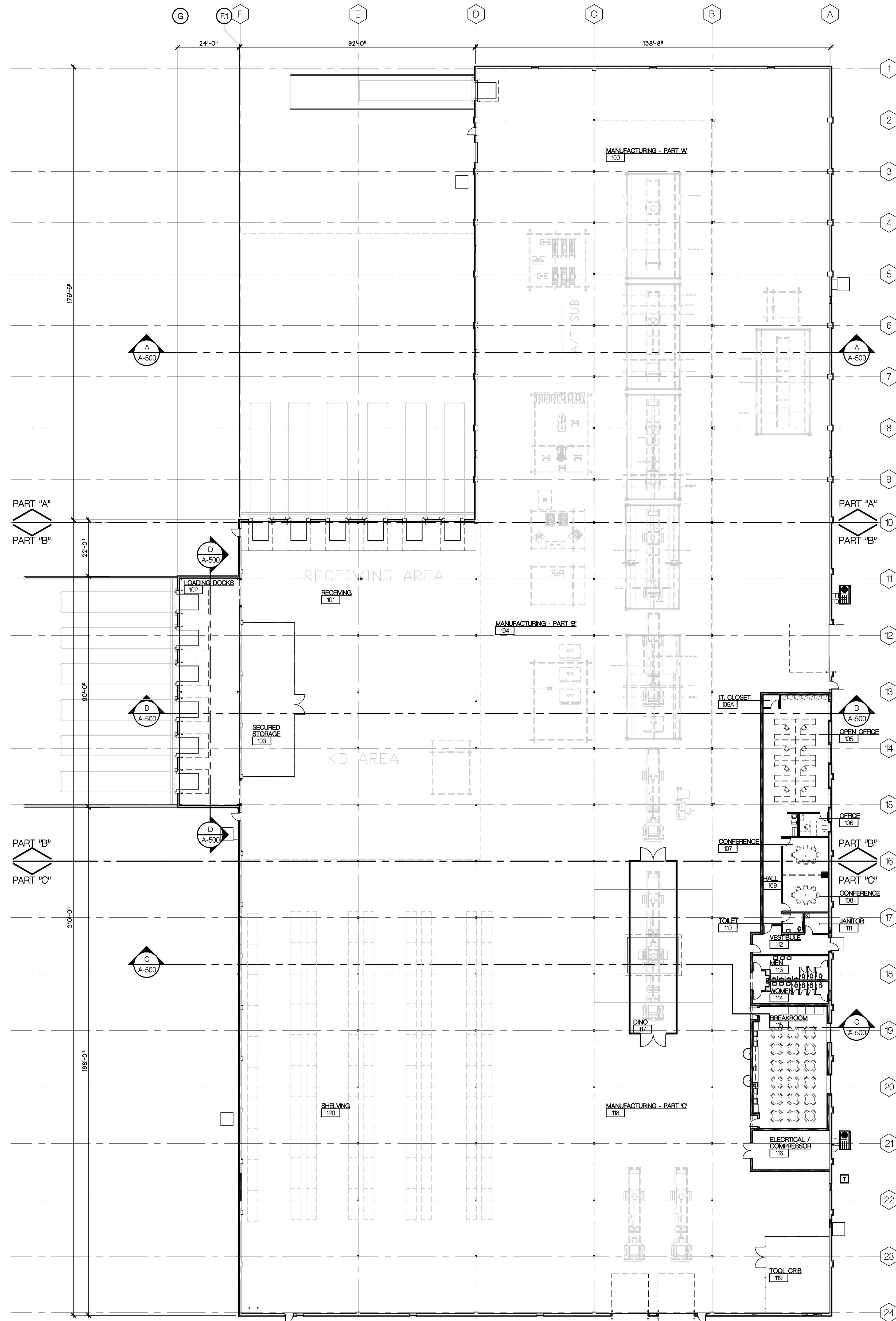

FLOOR PLAN GENERAL NOTES:

1. CONTRACTOR TO CHECK AND VERIFY ALL DIMENSIONS AND PROMPTLY NOTIFY ARCHITECT OF ANY DISCREPANCIES.
2. ALL DIMENSIONS ARE TO CENTER OF COLUMN, FACE OF EXISTING WALL, CENTER OF INTERIOR STUD WALL, FACE OF EXTERIOR WALL, OR FACE OF MASONRY WALL, UNLESS NOTED OTHERWISE.
3. MAIN LEVEL ELEVATION (USGS) _____
 REFERENCE MAIN LEVEL FINISHED FLOOR = 100'-0"
4. ALL EXTERIOR SLABS TO SLOPE AWAY FROM THE BUILDING.
5. ALL WALLS SHALL EXTEND TO ROOF OR FLOOR DECKING ABOVE UNLESS OR DETAILED NOTED OTHERWISE.
6. SEE SHEET A-111 FOR INTERIOR WALL TYPES.
7. CONTRACTOR SHALL INSTALL ALL WOOD BLOCKING IN STUD AND GYPSUM WALLS REQUIRED FOR ANCHORAGE OF WALL ATTACHED ITEMS INCLUDING BUT NOT LIMITED TO RAILINGS, GRAB BARS, TOILET ROOM ACCESSORIES, DOOR BUMPERS, WOOD TRIM, CABINETS AND FUTURE I.T. ITEMS.

8. LEGEND:

- — — — — DENOTES 1 HOUR FIRE BARRIER CONSTRUCTION.
 - — — — — DENOTES 2 HOUR FIRE RATED WALL CONSTRUCTION.
- 9. ABBREVIATIONS:**
- CUH - CABINET UNIT HEATER
 - CJ - CONTROL JOINT
 - DS - DOWN SPOUT
 - FBX - ELECTRIC FLOOR BOX
 - FD - FLOOR DRAIN
 - FE - FIRE EXTINGUISHER & BRACKET
 - FEC - SEMI-RECESSED FIRE EXTINGUISHER & CABINET
 - MAU - MAKE UP AIR UNIT
 - REF - REFRIGERATOR (N.I.C.)
 - RTU - ROOF TOP UNIT (GROUND MOUNTED)
 - VEND - VENDING MACHINE (N.I.C.)



NORTH
COMPOSITE FLOOR PLAN
 SCALE - 1" = 20'



NORTH
KEY PLAN
 SCALE - N.T.S.

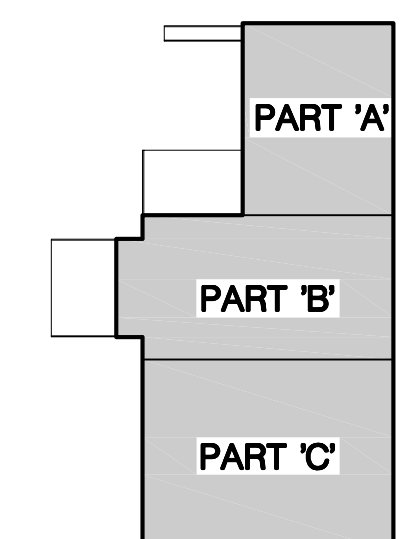

30% OWNER REVIEW 8-17-2015
 DATE ISSUED
 MJB
 DRAWN BY
 JFS
 CHECKED BY

HOBBS + BLACK
 ARCHITECTS
 117 E. Allegan Street
 Lansing, MI 48933
 P: 517.884.4870
 www.hobbs-black.com



PART A
 ELECTRICAL
 LIGHTING
 PLAN

SHEET TITLE

14-155
 PROJECT NUMBER

E-400
 SHEET NUMBER



ELECTRICAL KEY NOTES

① (INSERT TEXT HERE WITH "TEXT EDIT" COMMAND)

**FLOOR PLAN PART A
 ELECTRICAL - LIGHTING**

SCALE: 1/8" = 1'-0"

REVIEW
 DRAWING
 NOT FOR
 CONSTRUCTION
 PLOT DATE: 08-10-2015

